



S I A L I A

LUXURY ELECTRIC YACHTING

Make a statement with this new breed of distinct electric yachts. Step into a world of emission-free yachting and explore the beauty of nature. In pure silence.



[www.sialia-yachts.com](http://www.sialia-yachts.com)







## Electric yachting

The silence and comfort experienced on a Sialia yachts allows owners to fully immerse themselves in nature. Hearing only the waves as they cruise to their next destination. Waking up at anchor in unprecedented serenity.





The ultimate vessel for your next adventure.







Offering a state of the art user interface, full beach-club layout and abundant storage for toys, each Sialia is well-equipped for a great day at sea



Feel at home, regardless of the destination.



# 45 Range

The Sialia 45 combines our focus on sustainability with restrained athleticism. Creating a fast, easy to handle high performance electric day boat.





# Sialia 45 Sport

The ultimate expression of an electric day-boat. Using Sialia's globally optimized process resulted in extreme electric performance and ample range. It is the perfect entry point to experiencing electric yachting.



Passengers  
**12 people**

Motor power  
**2x 300 kW**

Top speed  
**43+ kn**

Max. battery capacity  
**700 kWh**

Max. range @25 knots  
**240 nM**



## SIALIA 45 Sport

The Sialia 45 is conceived as the ultimate expression of an electric day-boat. It offers ample performance and range for a fun filled day on the water or a weekend trip.

### Technical specifications

LOA	13.7 m   44.95 ft
Beam	4.1 m   13.45 ft
Draft	0.85 m   2.79 ft
Displacement	10 tons
Capacity	12
Certificate	CE-B
Speed	43+ kn
Material	Carbon



# 59 Range

Based on the hull of Sialia 57 'Deep Silence', a range of models was developed with improved design and higher levels of system integration. Using a proven foundation, each Sialia is tailored to be a unique reflection of the owners personal lifestyle and taste.





# Sialia 59 **Weekender**

A truly versatile cruiser for exploration in serenity and comfort.

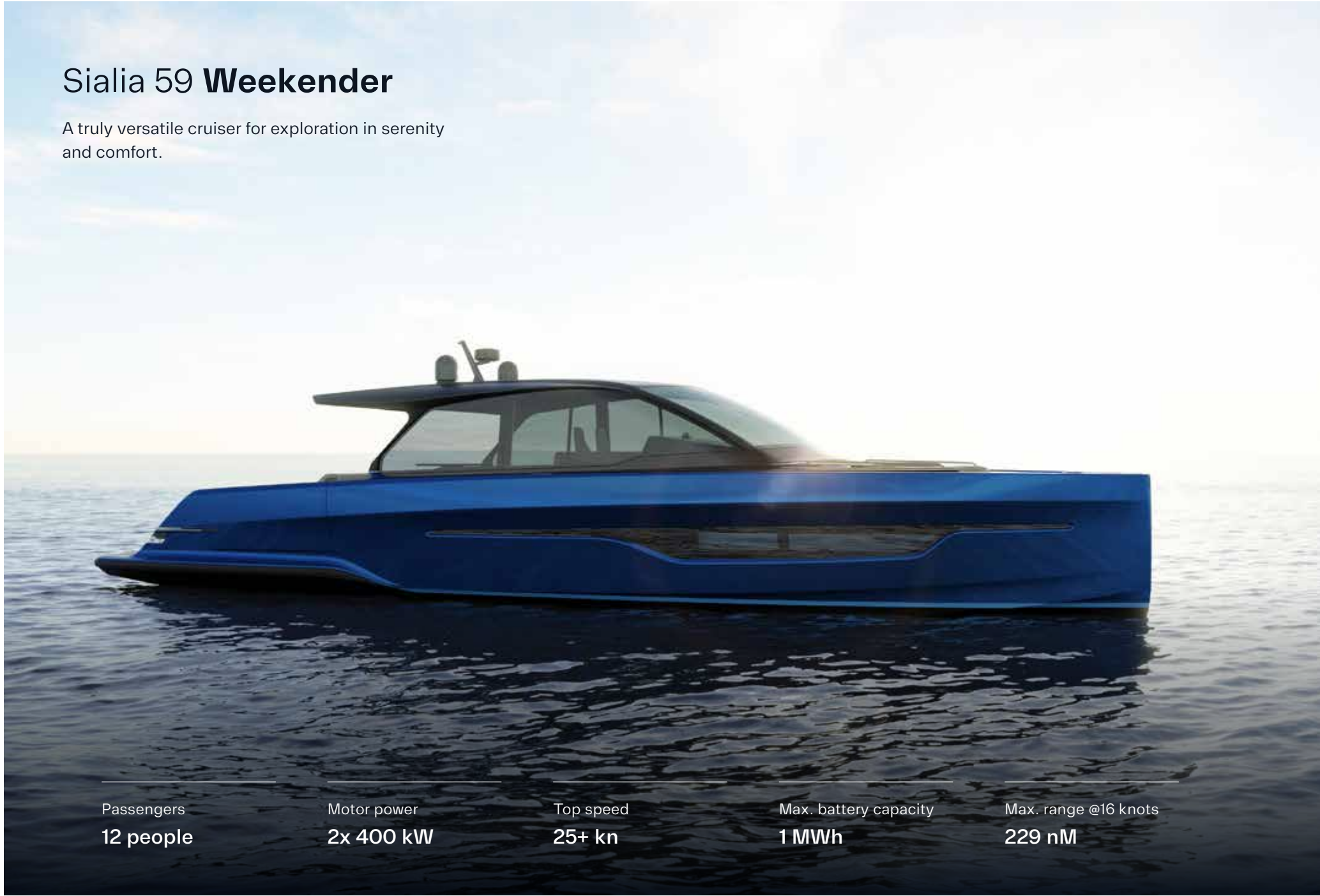

Passengers  
**12 people**

Motor power  
**2x 400 kW**

Top speed  
**25+ kn**

Max. battery capacity  
**1 MWh**

Max. range @16 knots  
**229 nM**



# 59



## SIALIA 59 Weekender

The weekender is designed for socializing. Key features are spacious climate-controlled cockpit, multiple lounge areas, a wide beach club with folding sides and tender garage for a 3.3m | 10.8 ft tender.

### Technical specifications

LOA	18 m   59.06 ft
Beam	5 m   16.45 ft
Draft	1 m   3.28 ft
Displacement	20 tons
Capacity	12
Certificate	CE-B
Speed	25+ kn
Material	Carbon





# Sialia 59 Runabout

A style icon defined by modern lines and an aesthetically pleasing symmetry.



Passengers  
**12 people**

Motor power  
**2x 400 kW**

Top speed  
**25+ kn**

Max. battery capacity  
**1 MWh**

Max. range @16 knots  
**229 nM**



# 59<sup>R</sup>



## SIALIA 59 Runabout

The runabout offers the epitome of style whether its dropping you off at your favorite restaurant or enjoying a quiet day on the lake. The spacious lounge, inspired by private jets, provides sleeping accommodation for up to four guests and one crew member.

### Technical specifications

LOA	18 m   59.06 ft
Beam	5 m   16.45 ft
Draft	1 m   3.28 ft
Displacement	19 tons
Capacity	12
Certificate	CE-B
Speed	25+ kn
Material	Carbon

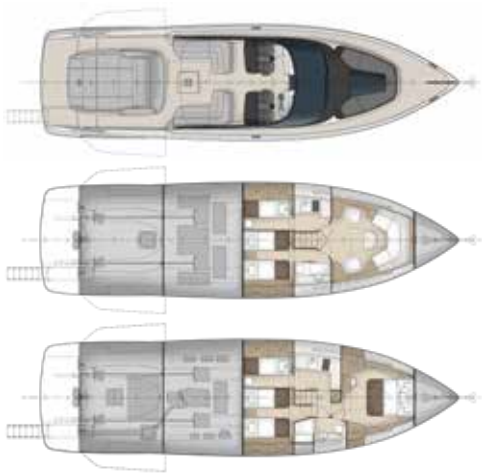



# Sialia 59 Sport

A fast center-console day cruiser with abundant deck space.



Passengers  
12 people

Motor power  
2x 400 kW

Top speed  
25+ kn

Max. battery capacity  
1 MWh

Max. range @16 knots  
229 nM



# 59<sup>s</sup>



## SIALIA 59 Sport

Indulge in dynamic elegance aboard our center-console cruiser. Sunbathe on spacious decks, savor the silent drive from the helm, and unwind in the lavish interior.

### Technical specifications

LOA	18 m   59.06 ft
Beam	5 m   16.45 ft
Draft	1 m   3.28 ft
Displacement	19 tons
Capacity	12
Certificate	CE-B
Speed	25+ kn
Material	Carbon

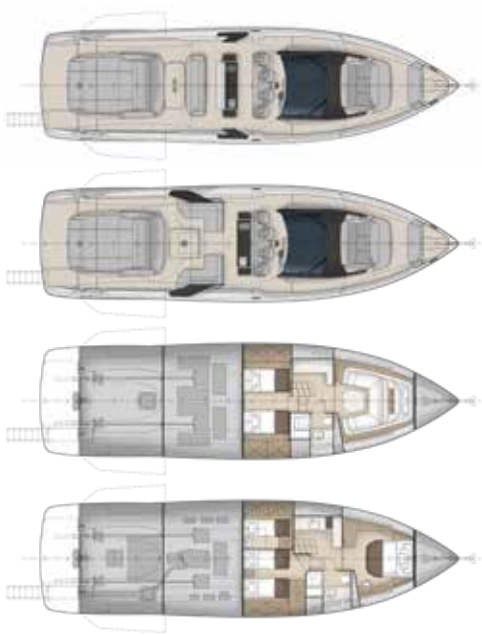



# Sialia 59 Loft

The silent and emission free superyacht chase boat.

Passengers  
12 people

Motor power  
2x 400 kW

Top speed  
25+ kn

Max. battery capacity  
1,5 MWh

Max. range @16 knots  
229 nM



# 59



## SIALIA 59 Loft

The loft is an expression of Sialia's ecosystem approach on a superyacht chase boat. It extends the benefits of silent and emission free nights at anchor to the mothership, providing energy from its batteries.

### Technical specifications

LOA	18 m   59.06 ft
Beam	5 m   16.45 ft
Draft	1 m   3.28 ft
Displacement	21 tons
Capacity	12
Certificate	CE-B/C
Speed	25+ kn
Material	Carbon Epoxy Sandwich

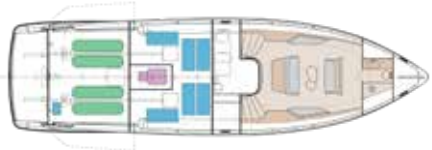



# Sialia 80 Explorer

Using the proven efficiency and electric drivetrain thought leadership of Sialia the 80 explorer delivers the ultimate vessel for any adventure.





# Sialia 80 Explorer

Combining the naval design expertise of Vripack and Sialia's electric yacht expertise the explorer embodies long range electric cruising in full comfort.



Passengers  
**12 people**

Motor power  
**2x 400 kW**

Top speed  
**11+ kn**

Max. battery capacity  
**1 MWh**

Max. range @8 knots  
**3495 nM**



# 80<sup>E</sup>



## SIALIA 80 Explorer

Using the proven efficiency and electric drivetrain thought leadership of Sialia the 80 explorer delivers the ultimate vessel for any adventure.

### Technical specifications

LOA	26.6 m   87.27 ft
Beam	8.5 m   27.84 ft
Draft	1 m   3.28 ft
Displacement	19 tons
Capacity	12
Certificate	CE-A
Speed	11+ kn
Material	Aluminium

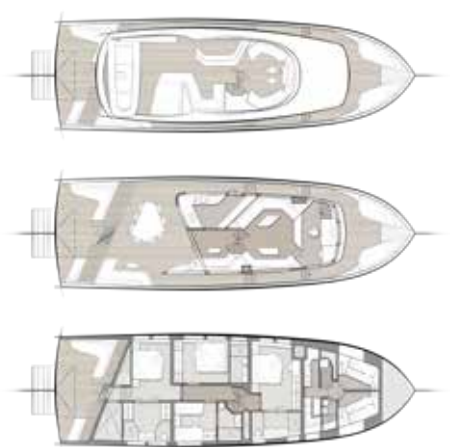





## Create a distinguishing design

Sialia yachts embody their owners' essence. With personalized designs and our integrated design approach, we redefine electric yachting.



## Electric performance

Designing an electric yacht requires a unique approach. Every aspect, from the sleek hull to the lightweight luxury interior, must harmonize seamlessly to realize a high-performance electric yacht.

Achieving peak performance in electric yachts demands meticulous engineering. Our approach mirrors race car design, constantly optimizing weight, balance, naval architecture, and secondary systems for sustainable performance and longevity.

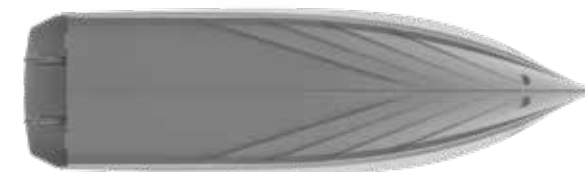

## Optimized hull design

The hulls designed by renowned naval architects like Vripack and Petestep maximize the electric drivetrain. It combines low resistance, and superior balance to provide an effortless, dry ride with no planing hump and excellent tracking.



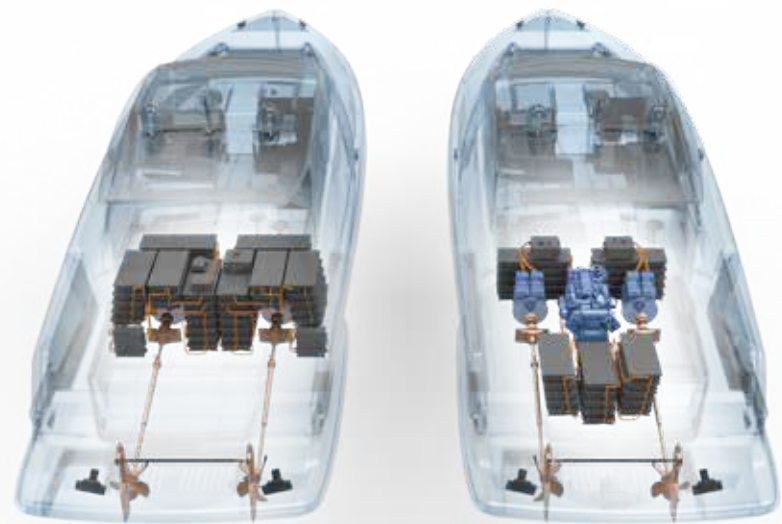

## Drivetrain technology by AMPROS

The Ampros system achieves unparalleled storage capacity, efficiency, output, cooling and safety in the leisure marine industry. A range of battery capacities and range extender options are available. With the implementation of a Ship Management System (SMS) failures caused by misuse or abuse of the system are eliminated.

Sialia's are fitted with chargers to accept a range of power connections to facilitate charging in any situation. Sialia works with its customers to determine the right charging infrastructure for their application.

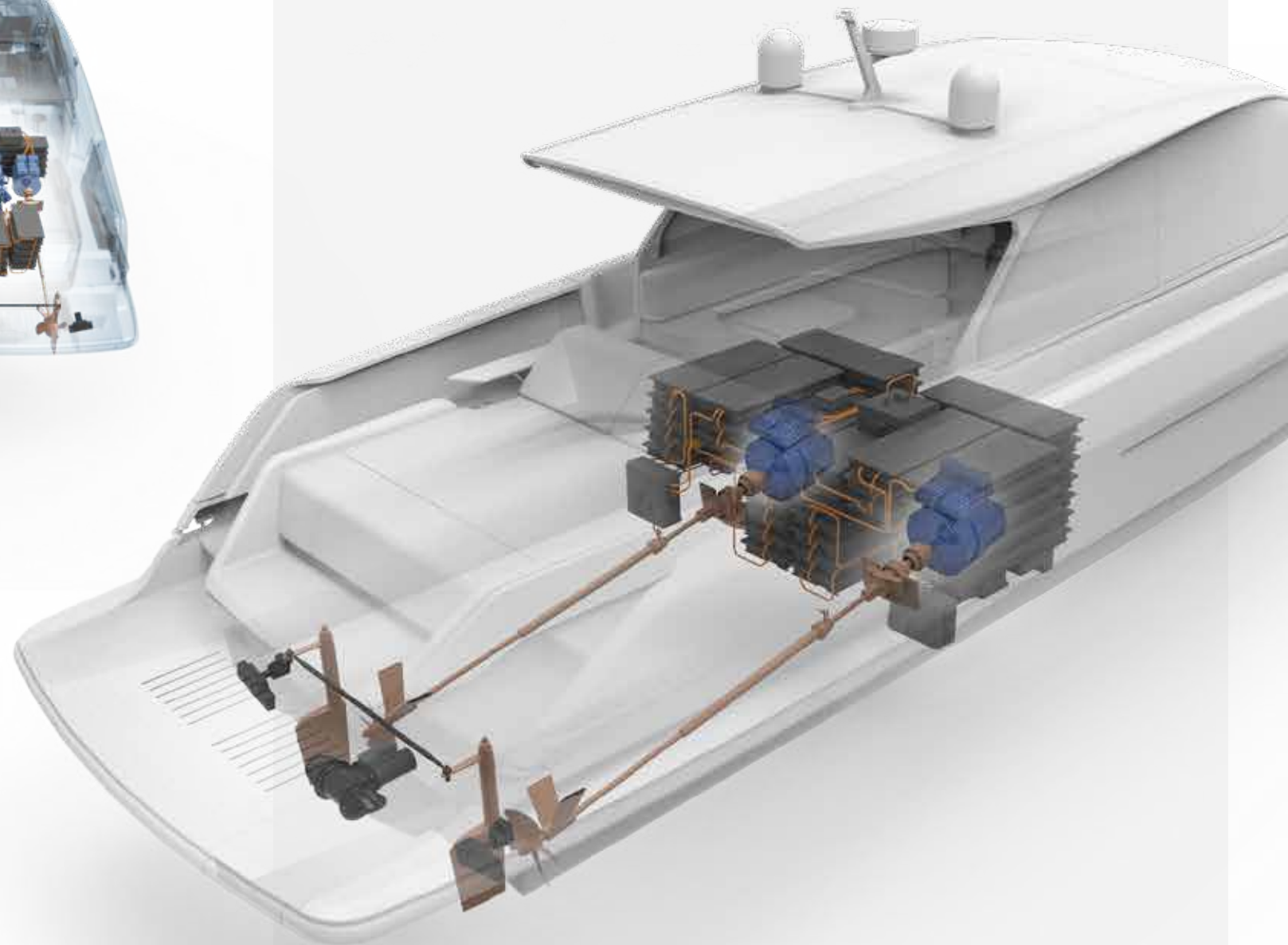

## Accelerating the energy transition forward drives us

The full lifecycle is considered in the design of our yachts. Be it in the selection of materials to the way a Sialia integrates into an energy ecosystem and even augments it. When charging the yacht will not destabilize the energy grid. Even integration with local sustainable energy sources to store and supply back renewable energy to a customers house is an option.





Sialia 45 Sport Specs

Drivetrains

**Performance:** Lightweight carbon construction and maximized, pure electric performance. Providing speed and ample range for daytrips.

**Range:** Striking the perfect balance between bursts of pure electric performance and long-range cruising using a range extender and carbon construction.



Packages

**Standard Pack:** Provides all the experiences of electric yachting including select options The easiest entry to electric yachting.

**Plus Pack:** The plus pack provides the same or better equipment as the standard and premium detailing.

**Premium Pack:** The top of the range model includes all the amenities one expects and superyacht quality finish.



Power	2x 300 kW	2x 300 kW	2x 300 kW	2x 300 kW	2x 300 kW
Battery	300 kWh	500 kWh	700 kWh	300 kWh	500 kWh
Range Extender	x	x	x	140 kW / 350kW	140 kW / 350kW
Range	24 nm	55 nm	77 nm	142 nm / 224 nm	164 nm / 240 nm
Charging 22kW / 150 KW DC*	11 / 1,5	18,5 / 3	26 / 4	11 / 1,5	18,5 / 3

Sialia 59 Specs

Charging

**Energy Storage**  
Various energy storage solutions are offered to provide the optimal system for your requirements.

**Batteries**  
Our Sialia 1000 flagship capacity facilitates the purest electric experience while underway and at anchor. The Sialia 700 battery balances similar performance with a lower weight and cost. The Sialia 350 combines electric performance and long range cruising with the use of range extender

**Chargers:**  
As standard all Sialia's are fitted with a 22kW charger connected through shorepower. If local infrastructure multiple fast charger options are offered.

**Range extenders:**  
Sialia yachts can be configured with variable rpm, bio-diesel certified, range extenders that offer cruising at 16 knots to a compact unit for increased autonomy and speeds up to 10 knots. Depending on local infrastructure, hydrogen fuel cells are an option for ultimate sustainable cruising.

Capacity

	Sialia 1000	Sialia 700	Sialia 350   REX
Battery capacity	1000 kWh	700 kWh	350 kWh   + 390 Kwh
Range @ 8 kn	114 nm	80 nm	40 nm   571 nm
Range @ 16 kn	46 nm	32 nm	16 nm   229 nm
Range @ 25 kn	33 nm	23 nm	12 nm   24 nm

Charging

	1000 kWh	700 kWh	350 kWh
150 kW DC*	5.8	3.8	1.9
50 kW DC	17.3	11.5	5.6
2x 22 kW 3-phase*	19.6	13.1	6.4
1x 22 kW 3-phase	39.3	26.2	12.7

\* Time to charge from 10% to 90% state of charge in hours

Time to charge in hours from 10% to 90% State of Charge  
\* Depending on the selected (model and battery) configuration a 100 kW Range extender can be fitted for autonomous charging and extended low speed cruising.



# Let's start creating your sustainable yacht together



**Stanislav Szadkowski**  
Founder & CEO

50 years of experience in entrepreneurship and advanced technology. 15 years of experience as one of the main sponsors of ICPT, one of the most innovative companies in the lithium-ion traction battery market. At the same time, Stan's passion for sailing led him to contribute to the creation of Sialia yachts.



**Tomasz Gackoski**  
Founder & CEO

An engineer with 11 years of experience in the development of advanced lightweight structures. Participated in more than 30 marine projects related to carbon composites and innovative solutions. He has participated in the development of cutting-edge technologies for traction batteries.

Disclaimer: Technical data and graphic reproductions are indicative and refer to standard models. The only indications binding on the seller are contained in the act of purchase. September 2024



Sialia Yachts, a brand of Silent Straits, reserves the right to modify specifications, design elements, features, or performance data without prior notice. All performance figures and renderings are indicative and provided for general guidance only. This information shall not constitute a contractual offer or guarantee, and is subject to change in line with product development and continuous improvement.





S I A L I A  
LUXURY ELECTRIC YACHTING

[www.sialia-yachts.com](http://www.sialia-yachts.com) | [info@sialia-yachts.com](mailto:info@sialia-yachts.com)